

Notes

1. Do not scale this drawing. All dimensions must be checked/ verified on site. If in doubt ask.
2. This drawing is to be read in conjunction with all relevant architects, engineers and specialists drawings and specifications.
3. All dimensions in metres unless noted otherwise. All levels in metres unless noted otherwise.
4. Any discrepancies noted on site are to be reported to the engineer immediately.

KEY

— Highway boundary

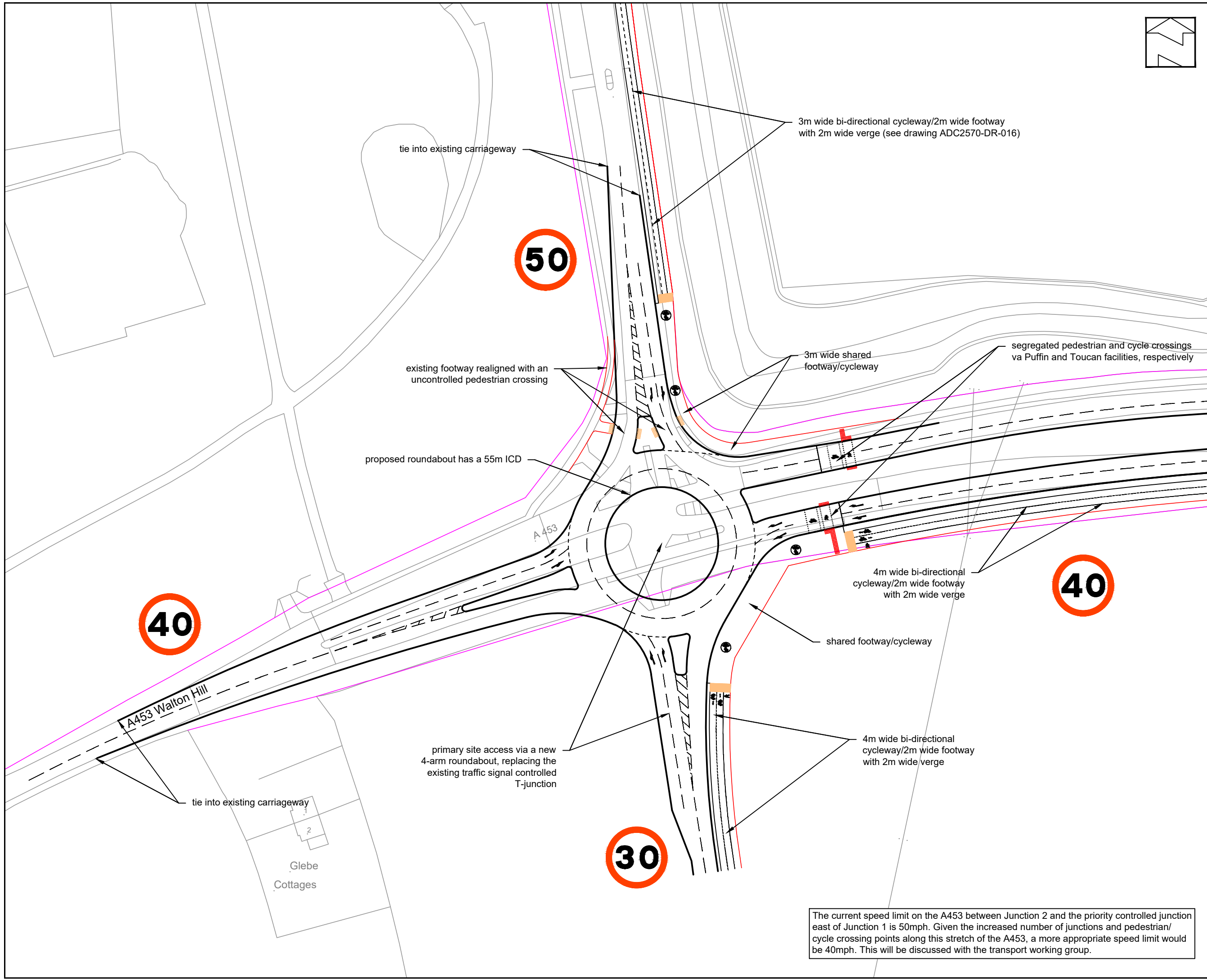

Rev	Date	Description	Dr	Rev
P5	10.04.24	Proposed speed limits	MH	DAC
P4	15.02.24	Converted to roundabout	MH	DAC
P3	14.04.23	Pegasus comments	AB	DAC
P2	29.03.23	cycle infrastructure updated	AB	DAC
P1	06.05.22	first version	MH	DAC

Client:
Caesarea/Harworth Group

Project:
Isley Woodhouse

Title:
Proposed A453 site access roundabout (Junction 2)



Drawn: M. Higgins
Reviewed: D. Cummins

Size: A3
Scale: 1:1000
Date: 05 / 05 / 2022

Status: **PRELIMINARY ISSUE**

Project Reference	Type	Number	Revision
ADC2570-DR-		003	P5

The current speed limit on the A453 between Junction 2 and the priority controlled junction east of Junction 1 is 50mph. Given the increased number of junctions and pedestrian/ cycle crossing points along this stretch of the A453, a more appropriate speed limit would be 40mph. This will be discussed with the transport working group.